

**STEP 1.** PLACE HEATER HALF ON BARREL IN DESIRED POSITION. MARK AROUND BARREL AT BOTH ENDS OF HEATER. CALCULATE NUMBER OF LAYERS OF GASKET REQUIRED BY SUBTRACTING THE BARREL DIAMETER FROM THE INSIDE DIAMETER OF HEATER AT ENDS AND THEN DIVIDING THE DIFFERENCE BY 0.118" OR 3mm. IF MORE THAN 5 LAYERS YOU NEED A SMALLER HEATER. ROUND NUMBER TO NEAREST WHOLE NUMBER.

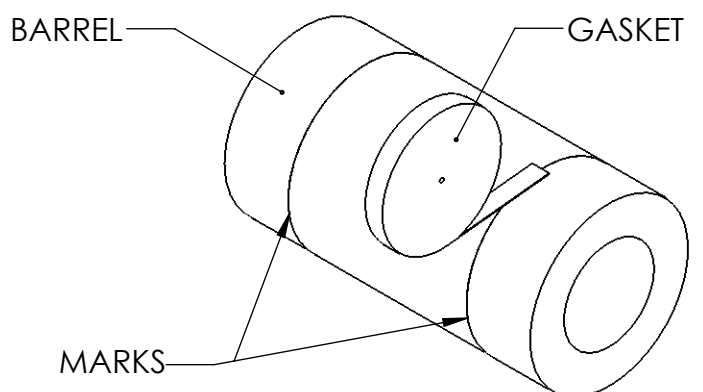

**STEP 2.** CENTER GASKET ON MARK AND WRAP CALCULATED NUMBER OF LAYERS ONTO BARREL. CUT GASKET AND CLIP IN PLACE. WHEN ONE SIDE IS COMPLETED SET COIL ON TO CHECK FIT. ADD OR SUBTRACT LAYERS AS NECESSARY.

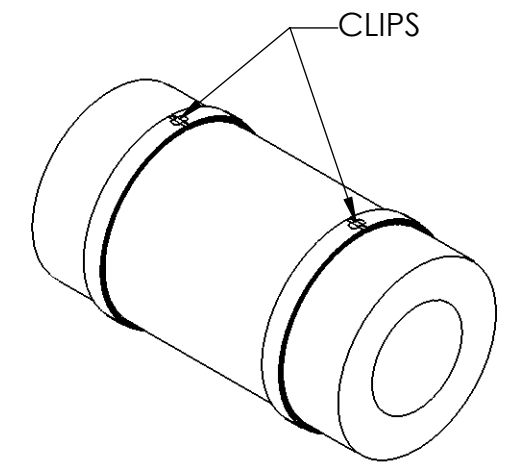

**STEP 3.** ASSEMBLY SHOULD LOOK LIKE DIAGRAM WHEN READY TO INSTALL HEATERS.

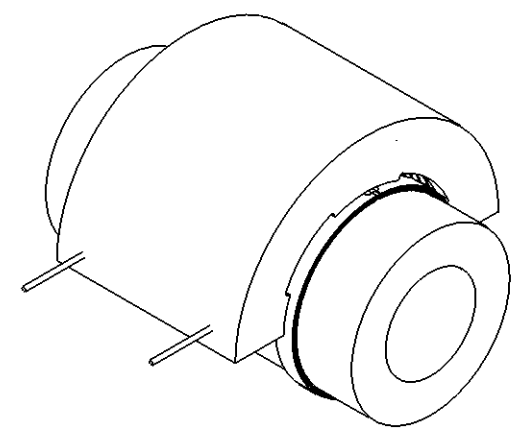

**STEP 4.** CAREFULLY PLACE HEATER OVER GASKET. IF GASKET DIAMETER IS TOO LARGE, DO NOT FORCE HEATER. HEATER MAY BE DAMAGED IF FORCED OVER TOO LARGE OF A DIAMETER.

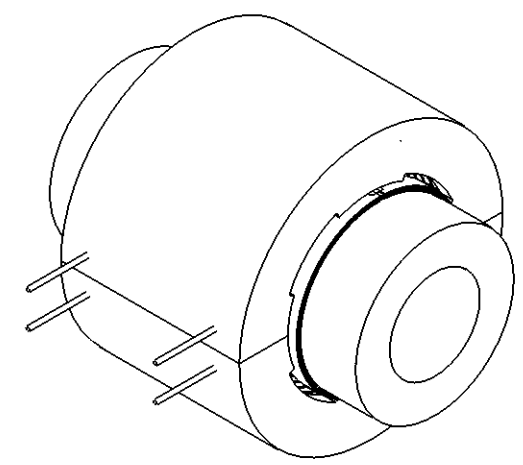

**STEP 5.** CAREFULLY PLACE BOTTOM HEATER ON BARREL.

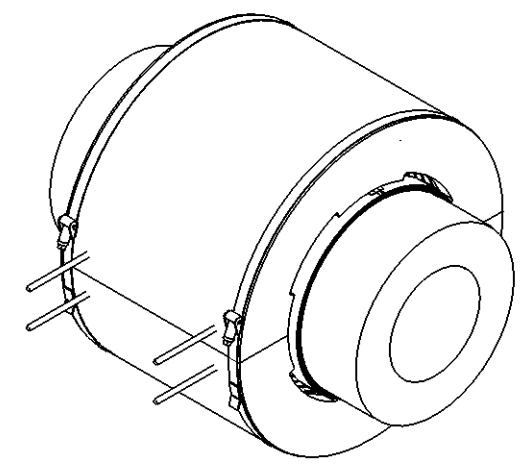

**STEP 6.** PLACE BAND CLAMPS OVER HEATERS AND TIGHTEN. CONTINUE WITH STANDARD INSTALLATION OF TCS HEATERS.

| DATE | ECO | REV | DESCRIPTION OF CHANGE | NAME |
|------|-----|-----|-----------------------|------|
|      |     |     |                       |      |
|      |     |     |                       |      |
|      |     |     |                       |      |
|      |     |     |                       |      |
|      |     |     |                       |      |
|      |     |     |                       |      |
|      |     |     |                       |      |
|      |     |     |                       |      |
|      |     |     |                       |      |
|      |     |     |                       |      |

| PROPRIETARY INFORMATION   |                  |                       | TOLERANCE                   |                    |
|---|------------------|-----------------------|-----------------------------|--------------------|
| THIS DRAWING AND THE CONTENTS THEREOF CONTAIN TRADE SECRETS AND CONFIDENTIAL PROPRIETARY INFORMATION OF RMG TECHNOLOGIES INC. |                  |                       | UNLESS OTHERWISE SPECIFIED  |                    |
| REPRODUCTION OR THE USE OF THIS INFORMATION IS PROHIBITED WITHOUT THE PRIOR WRITTEN CONSENT OF RMG TECHNOLOGIES INC.          |                  | ANGULAR               | DECIMAL                     |                    |
| DESIGNED:   | NAME: <b>GRS</b> | DATE: <b>03/10/16</b> | ±                           | °                  |
| CHECKED:  | +                | +                     | .XX                         | ±                  |
| APPROVED:   | +                | +                     | .XXX                        | ±                  |
| MATERIAL:   |                  |                       | DO NOT SCALE DRAWING        |                    |
| SCALE: <b>1:8</b>   |                  |                       | SHEET: <b>1</b> OF <b>1</b> | DWG SIZE: <b>B</b> |

**RMG**  
 Rex Materials Group  
 1600 BREWER ROAD HOWELL, MI 48855  
 (517) 223-3787 WWW.REXMATERIALS.COM

TITLE: **GASKET INSTALLATION GUIDE**

DWG NO: **DOC-006691** REV: